



Images shown with optional features.



VENDEE

Escape the everyday in your own country retreat. Blending rural character with modern looks, Vendee Lodge offers residential specification for year-round getaways in the utmost comfort, with a welcoming interior providing plenty of room for the whole family.



Visit swiftgroup.co.uk to watch our 2020 range video





FLEXIBLE SEATING
 Freestanding two and three-seater sofas with scatter cushions, plus complementary footstool with storage



FEATURE FIRE
 Contemporary electric 2kW Optiflame® stove feature fire creates a cosy feel



COUNTRY KITCHEN
 Classic country style kitchen with Belling stainless steel oven, white resin bowl and copper finish tap



FAMILY DINING
 Elegant wooden dining table with four padded combo chairs, ideal for entertaining

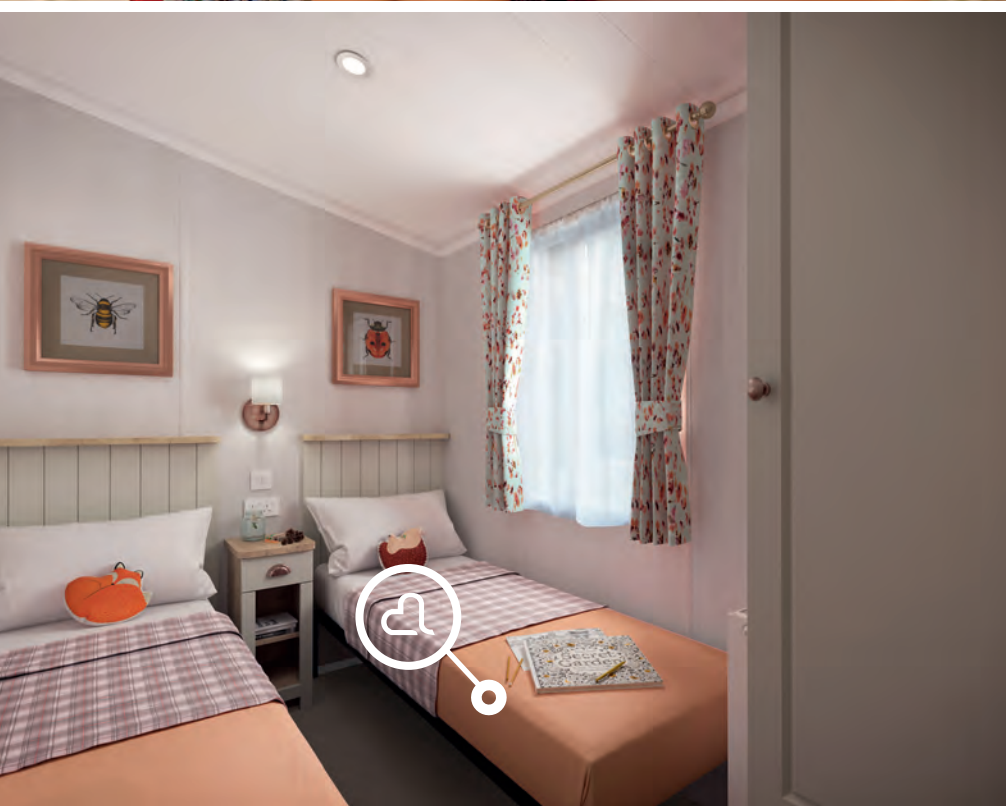

CLOAKROOM STORAGE

Shelving and seat bench featuring coat hooks and shoe storage in hallway, keeping everything tidy



DUVALAY™ MATTRESSES

Duvalay™ Alba Ortho mattress to king-size master bed (with lift-up storage) and Crib 5 rated Duvalay™ mattresses to singles



VANITY AREA

Dressing table with large mirror, lighting and storage in master bedroom, next to handy window seat



LUXURY BATHROOMS

Family and en suite bathrooms, each with shower cubicle and thermostatic shower, ample storage and heated towel rails

FEATURES

EXTERIOR

- Residential specification enhanced to BS3632:2015
- Strong I Beam twin-axle chassis with galvanised finish, warrantied for 10 years
- Bonded 'sandwich' exterior wall construction for greater strength
- Coated steel pantile roof
- Distinctive pre-coated 'folded' steel bargeboards with LED lighting to front aspect
- CanExel high density wood composite cladding with durable, realistic woodgrain texture in 'Mist Grey' with anthracite glazing
- Double French door to front aspect
- uPVC windows with push-button security locks
- PVC gutters and down pipes

INSULATION

- Excellent thermal performance and sound insulation:
 - Thermaglas™ uPVC double glazed windows and doors with improved thermal rating
 - Composite SIPs (Structural Insulated Panel) floor
 - 200mm insulation in roof
 - 95mm insulation in walls
 - Lagged underfloor pipes

INTERIOR

- 'Amalfi' soft furnishing scheme
- Luxury carpet with underlay throughout
- Hardwearing vinyl flooring in 'Almeria' for the kitchen/dining/bathroom(s)
- Low energy LED lighting throughout
- Modern planked ceiling system gives a smoother finish with only one central seam
- Nebraska Oak woodgrain
- Good provision of double electric sockets throughout with dedicated USB points
- Freestanding 2 and 3 seater sofas with scatter cushions
- Complementary footstool with storage
- Contemporary electric 2kW Optiflame® stove feature fire with mirror over fireplace
- TV unit with storage, TV provision and Sky TV cable for connection only to TV cabinet
- White slatted wooden blinds
- Full height luxury curtains to front aspect
- Contemporary framed colour wall pictures
- Central Tyler copper effect pendant light feature

KITCHEN / DINING

- Belling stainless steel oven
- Integrated silver extractor hood vented to outside
- 5-burner gas hob with electronic ignition
- Brown Mountain Larch splashbacks
- Integrated microwave oven with digital controls (800w)
- A+ rated double door integrated fridge and freezer
- White resin bowl and drainer with copper finish tap
- 40mm Brown Mountain Larch laminate worktops
- Kitchen with country classic feel. Cupboards in 'Dakar' with larch woodgrain details, and metallic cup door and drawer handles
- Integrated wine rack
- 'Florence' dining table in 'Nebraska' / 'Painted Porcelain' with 4 Combo chairs

HALLWAY

- Seat bench featuring coat hooks and shoe storage
- Large mirror and shelving unit

BATHROOM(S)

- Shower cubicle with thermostatic shower, topper and LED downlight
- Dual flush WC with soft close toilet seat
- Vanity storage unit with mirror above
- Additional side storage cupboards
- Extractor fan in both bathrooms
- White heated towel rails

BEDROOMS

- King-size Alba Ortho double bed in main bedroom with lift up storage
- Duvalay™ mattress to all beds with Crib 5 rated fabric
- Padded headboard in master bedroom
- Wall mounted bedside lights
- Ample storage with bedside units and over bed cupboards in the master bedroom
- Dressing table with mirror, lighting and storage
- Window seat and TV panel with credenza drawer unit in master bedroom
- Nature inspired wall pictures

OPTIONS

- CanExel exterior in 'Acadia Green' with anthracite glazing
- CanExel exterior in 'Sierra Brown' wood finish with rustic oak glazing
- SwiftShield stain resistant fabric
- Wireless programmable room thermostat with gas central heating
- Lux pack, including dishwasher, washing machine, kitchen VELUX and Bluetooth® audio connection to lounge ceiling speakers
- TV sockets and Co-Ax to all bedrooms, plus booster
- Shaving socket in bathroom
- Premium comfort 22" high queen-size airbed for additional sleeping space with built-in electric pump

FLOORPLAN

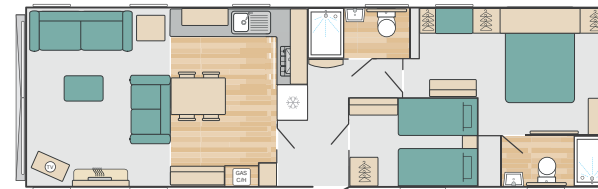

42' x 13' - 2 Bedroom

STANDARD FEATURES



Galvanised Chassis



Double Glazing



Central Heating Boiler



Cooker



Fridge Freezer



Microwave



TV Point



Electric Fire



Wardrobe



Duvalay™

BED SIZES

Model size	Bedrooms	Double	Twin
42' x 13'	2	2.02m x 1.53m (6'8" x 5'0")	1.90m x 0.75m (6'3" x 2'6")

